

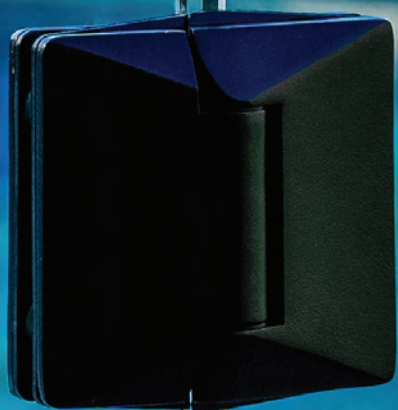

2205

SOFT CLOSE HINGE







SOFT CLOSE HINGE

530 Series GLASS TO GLASS HINGE SET

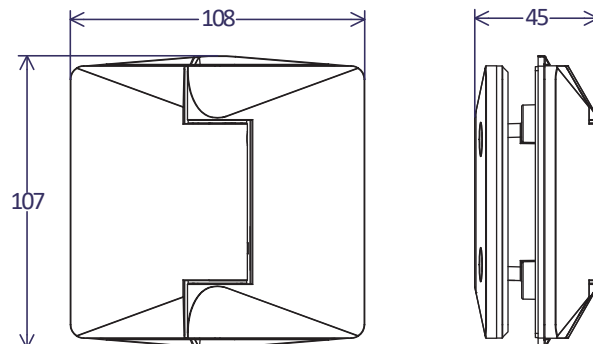

TECHNICAL DATA

- Duplex 2205 stainless steel
- Soft close with adjustable speed
- Single action
- Non-hold open
- Anti-foot hold non-climable
- 70 Kg max per pair of hinges
- Suitable for toughened glass 10-14mm (Maximum glass width 18mm)
- Maximum door size 950Wx2400H
- Passed 25,000 cycle test
- Fixings included
- Passed 640 hour salt spray test
- Finishes are satin, mirror polish, satin black powdercoat, satin white powdercoat and Satin gold

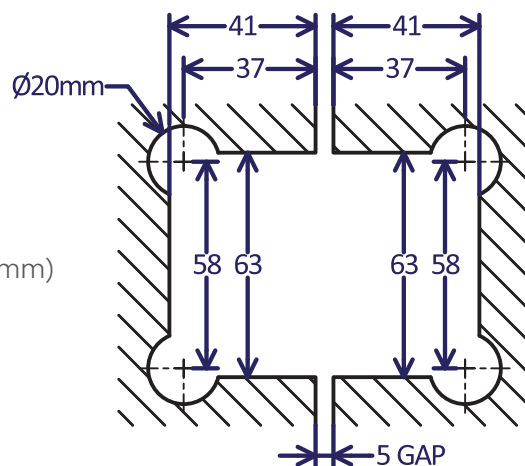

GLASS CUTOUT

- Sleek, slim profile
- Maintenance free
- Market leading warranty
- Fast installation
- No adjustment required

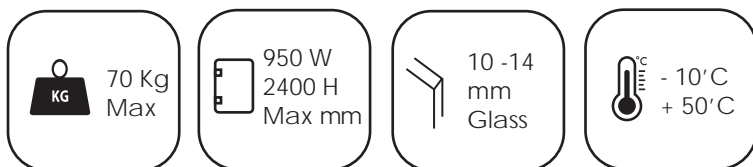

PRODUCT CODES



530G-P (Polished)



530G-S (Satin)



530G-B (Black)



530G-W (White)



530G-SG (Satin Gold)



GRADE 2205





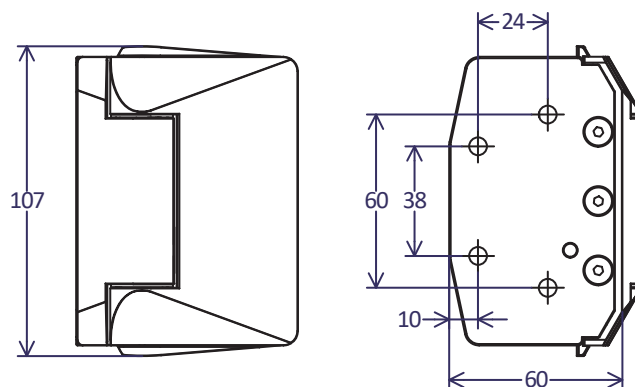

TECHNICAL DATA

- Duplex 2205 stainless steel
- Soft close with adjustable speed
- Single action
- Non-hold open
- Anti-foot hold non-climbable
- 70 Kg max per pair of hinges
- Suitable for toughened glass 10-14mm (Maximum glass width 18mm)
- Maximum door size 950Wx2400H
- Passed 25,000 cycle test
- Fixings included
- Passed 640 hour salt spray test
- Finishes are satin, mirror polish, satin black powdercoat, satin white powdercoating and satin gold

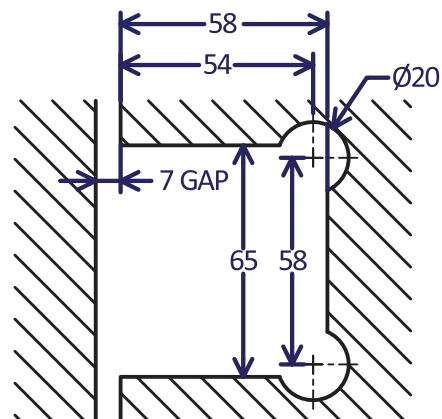

GLASS CUTOUT

Note for mounting to a 50mm square post you will require one set of 530SPB. For mounting on a 50mm round post you will require one set of 530RPB.

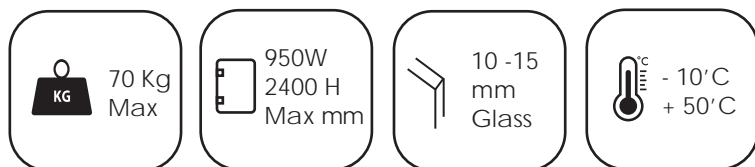

PRODUCT CODES



530W-P (Polished)



530W-S (Satin)



530W-B (Black)



530W-W (White)



530W-SG (Satin Gold)





SOFT CLOSE HINGE

530 Series SQUARE POST BRACKET SET

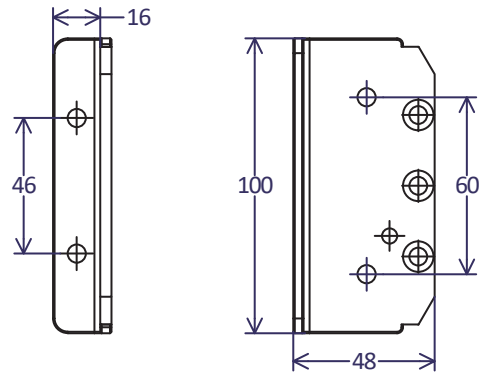

TECHNICAL DATA

- Duplex 2205 stainless steel
- To be used with 530 glass to wall hinge set 530W
- Glass position center of 50mm post

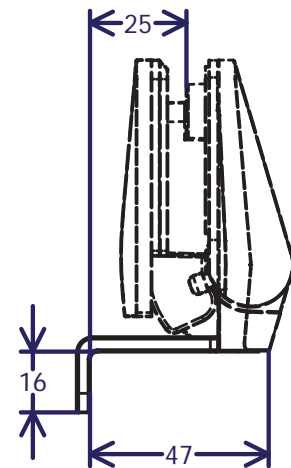

DIMENSIONS WITH HINGE

PRODUCT CODES



530SPB-P (Polished)



530SPB-S (Satin)



530SPB-B (Black)



530SPB-W (White)



GRADE 2205





SOFT CLOSE HINGE

530 Series ROUND POST BRACKET SET

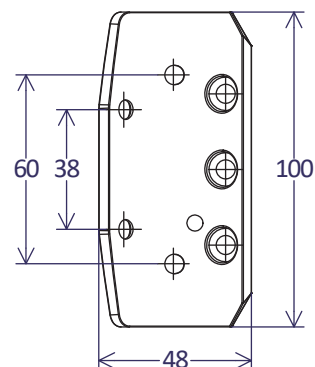
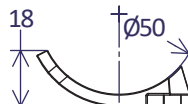

TECHNICAL DATA

- Duplex 2205 stainless steel
- To be used with 530 glass gate to wall hinge set 530W
- Glass position center of 50mm post

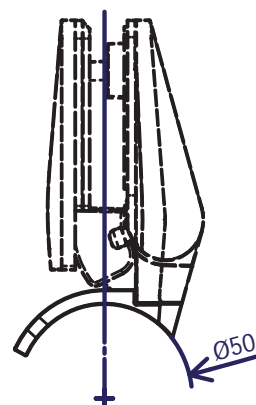

DIMENSIONS WITH HINGE

PRODUCT CODES



530RPB-P (Polished)



530RPB-S (Satin)



530RPB-B (Black)



GRADE 2205







SOFT CLOSE HINGE

LATCH Series 180 deg GLASS TO GLASS

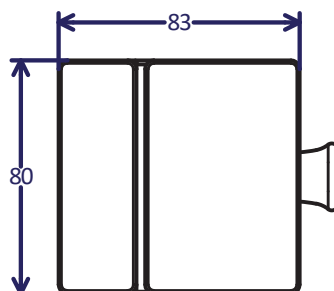

TECHNICAL DATA

- Duplex 2205 stainless steel
- Side pull latch
- Left or right hand opening
- Anti-foot hold non-climbable
- Suitable for toughened glass 10 - 12 mm gate and 12mm catch panel
- Passed 25,000 cycle test
- Fixings included
- Passed 640 hour salt spray test
- Finishes are satin, mirror polish, satin black powdercoat, satin white powdercoat and Satin gold

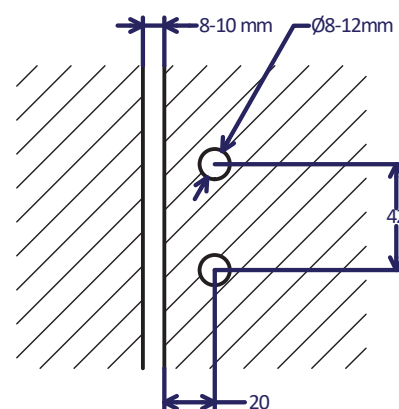
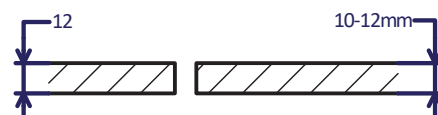

GLASS CUTOUT

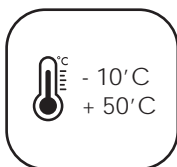

PRODUCT CODES



LAT180-P (Polished)



LAT180-S (Satin)



LAT180-B (Black)



LAT180-W (White)



LAT180-SG (Satin Gold)



GRADE 2205





SOFT CLOSE HINGE

LATCH Series 90 deg GLASS TO GLASS

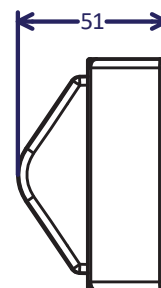
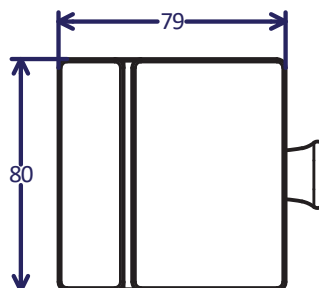

TECHNICAL DATA

- Duplex 2205 stainless steel
- Side pull latch
- Left or right hand opening
- Anti-foot hold non-climbable
- Suitable for toughened glass 10 - 12 mm gate and 12mm catch panel
- Passed 25,000 cycle test
- Fixings included
- Passed 640 hour salt spray test
- Finishes are satin, mirror polish, satin black powdercoat, satin white powdercoat and Satin gold

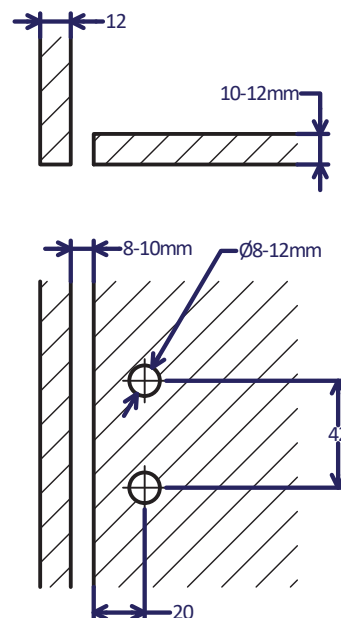

GLASS CUTOUT

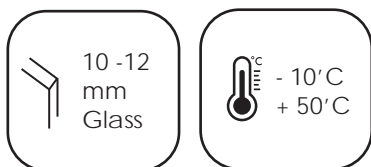

PRODUCT CODES



LAT90-P (Polished)



LAT90-S (Satin)



LAT90-B (Black)



LAT90-W (White)



LAT90-SG (Satin Gold)



GRADE 2205



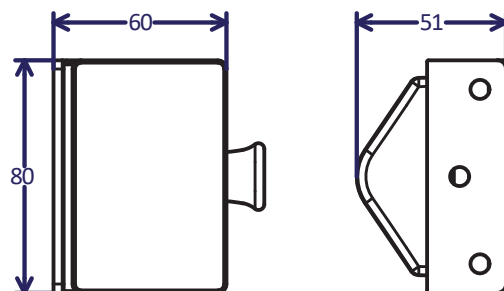

TECHNICAL DATA

- Duplex 2205 stainless steel
- Side pull latch
- Left or right hand opening
- Anti-foot hold non-climbable
- Suitable for toughened glass 10 - 12 mm gate and 12mm catch panel
- Passed 25,000 cycle test
- Glass fixings included
- Passed 640 hour salt spray test
- Finishes are satin, mirror polish, satin black powdercoat, satin white powdercoat and Satin gold

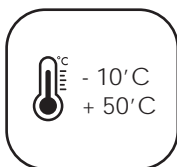
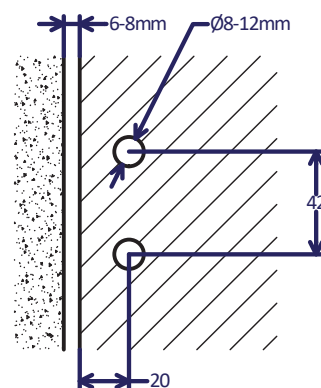
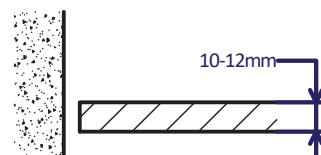

PRODUCT CODES



LATWALL-P (Polished)



LATWALL-S (Satin)



LATWALL-B (Black)



LATWALL-W (White)



LATWALL-SG (Satin Gold)



